

4V、3V300 Series Solenoid Valve,4A、3A 300 Series Pneumatic Control Valve



4A310-10

4V320-10

3A310-10

3V310-10

Ordering Code

4V 3 10 - 10 □ - AC220V - □

| Specification Code   | Series Code | Coil and Places  | Port Size            | Port connection and Initial State   | Standard Voltage  | Wiring Form   |
|--|-------------|--|----------------------|---|---|---|
| 4V:Two(Three)-position Five-way Solenoid Valve<br>4A:Two(Three)-position Five-way pneumatic control Valve<br>3V:Two-position Three-way Solenoid Valve<br>3A:Two-position Three-way Pneumatic Control Valve | 300 Series  | 10:Single-head Double-position<br>20:Double-head Double-position<br>30C:Double-head Three-position Close Type<br>30E:Double-head Three-position Exhaust Type<br>30P:Double-head Three-position Pressure Type | 08:G1/4"<br>10:G3/8" | NC:Two-position Three-way Normal Close Type<br>NO:Two-position Three-way Normal Open Type | DC12V<br>DC24V<br>AC24V 50Hz/60Hz<br>AC110V 50Hz/60Hz<br>AC220V 50Hz/60Hz<br>AC380V 50Hz/60Hz | Blank:Standard Connector<br>LD:Brown With Lighting Connector<br>LD1:White With Lighting Connector<br>W:Lead Wire Type |

Specifcation

| Model                    | 4V310-08                    | 4V320-08 | 4V330C-08                   | 4V330E-08 | 4V330P-08 | 4V310-10                    | 4V320-10 | 4V330C-10                   | 4V330E-10 | 4V330P-10 |
|--------------------------|-----------------------------|----------|-----------------------------|-----------|-----------|-----------------------------|----------|-----------------------------|-----------|-----------|
| Position and Way NO.     | Two-position Five-way       |          | Three-position Five-way     |           |           | Two-position Five-way       |          | Three-position Five-way     |           |           |
| Effective Sectional Area | 25mm <sup>2</sup> (CV=1.40) |          | 18mm <sup>2</sup> (CV=1.00) |           |           | 30mm <sup>2</sup> (CV=1.68) |          | 18mm <sup>2</sup> (CV=1.00) |           |           |

| Model                         | 3V210-08                           | 3V220-08 | 3A310-08 | 3A320-08 | 3V310-10                                | 3V2320-10 | 3A310-10 | 3A220-10 |
|-------------------------------|------------------------------------|----------|----------|----------|---|-----------|----------|----------|
| Position and Way NO.          | Two-position Three-way             |          |          |          | Two-position Three-way                  |           |          |          |
| Effective Section Area        | 25mm <sup>2</sup> (CV=1.40)        |          |          |          | 30mm <sup>2</sup> (CV=1.68)             |           |          |          |
| Joint Pipe Bore               | Air Inlet=Air Outlet=Exhaust=G1/4" |          |          |          | Air Inlet=Air Outlet=3/8" Exhaust=G1/4" |           |          |          |
| Working Medium                | 40 Micron Filtered Air             |          |          |          |   |           |          |          |
| Motion Pattern                | Inner Guide Type                   |          |          |          |   |           |          |          |
| Working-pressure              | 0.15~0.8 M Pa                      |          |          |          |   |           |          |          |
| Max. Pressure Resistance      | 1.2MPa                             |          |          |          |   |           |          |          |
| Operating Temperature         | 5~50℃                              |          |          |          |   |           |          |          |
| Voltage Range                 | ±10%                               |          |          |          |   |           |          |          |
| Power Consumption             | AC: 4.5VA DC: 3W                   |          |          |          |   |           |          |          |
| Insulation & Protection Class | F Class. IP65                      |          |          |          |   |           |          |          |
| Wiring Form                   | Lead Wire or Connector type        |          |          |          |   |           |          |          |
| Highest Action Frequency      | 5 Cycle / Sec                      |          |          |          |   |           |          |          |
| Shortest Excitation Time      | 0.05 Second                        |          |          |          |   |           |          |          |

4V、3V300 Series Solenoid Valve,4A、3A300 Series Pneumatic Control Valve

Overall Dimensions

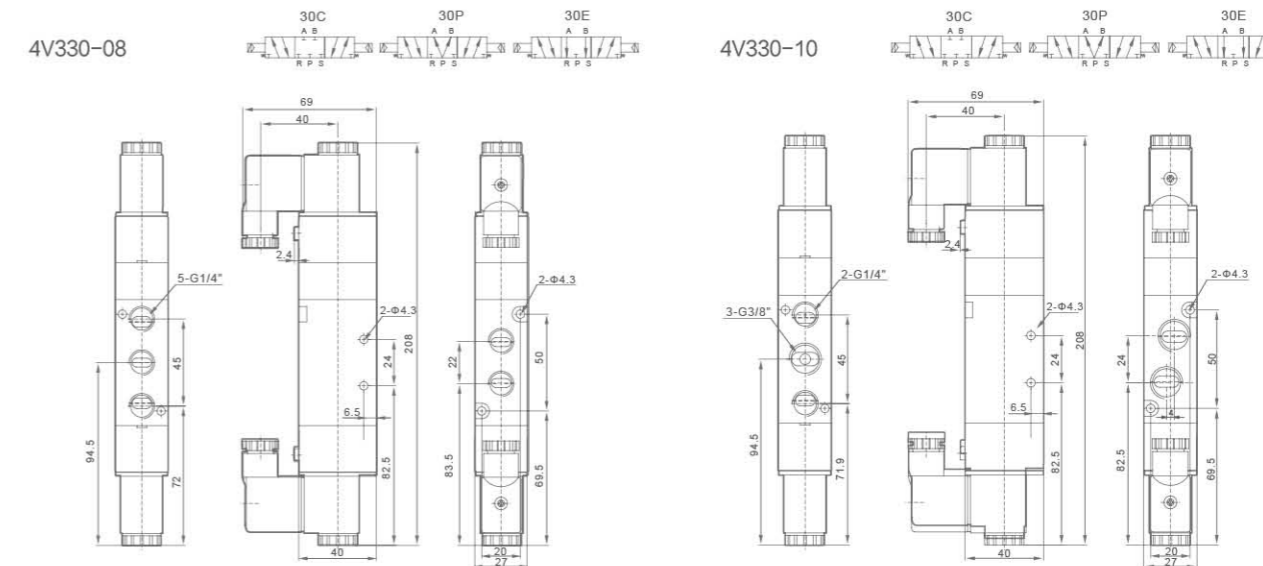
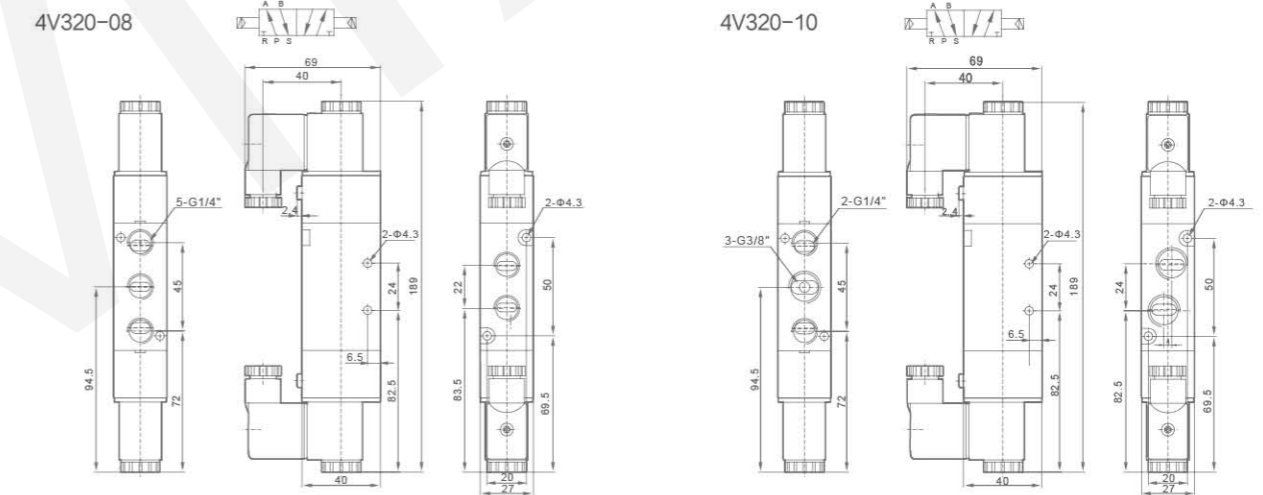
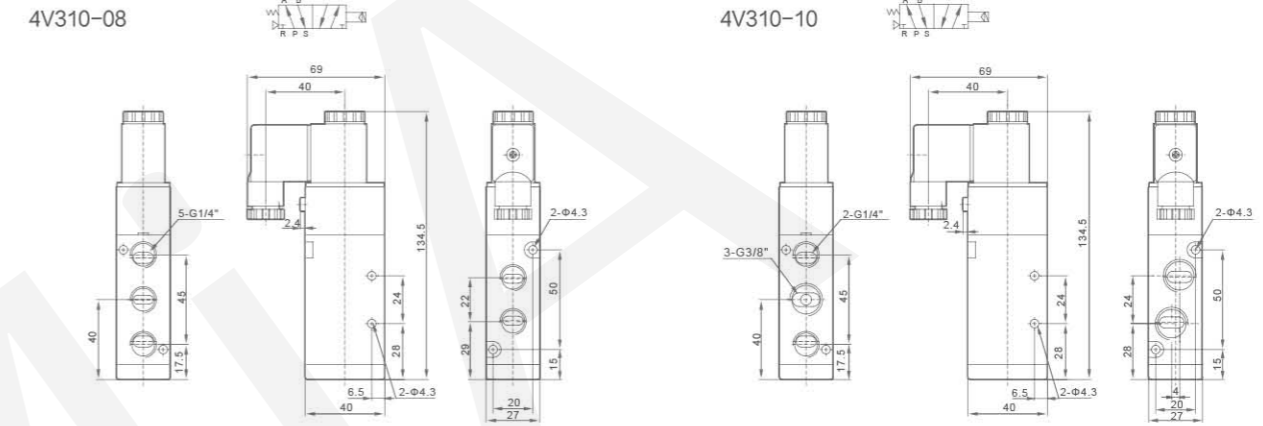

4V、3V300 Series Solenoid Valve, 4A、3A 300 Series Pneumatic Control Valve

Overall Dimensions

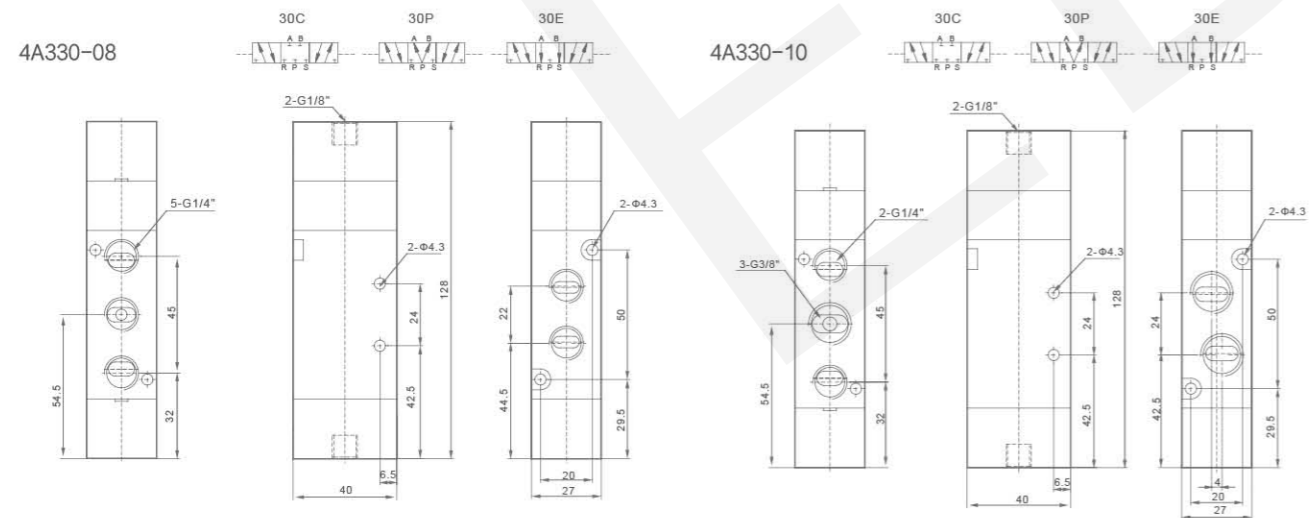
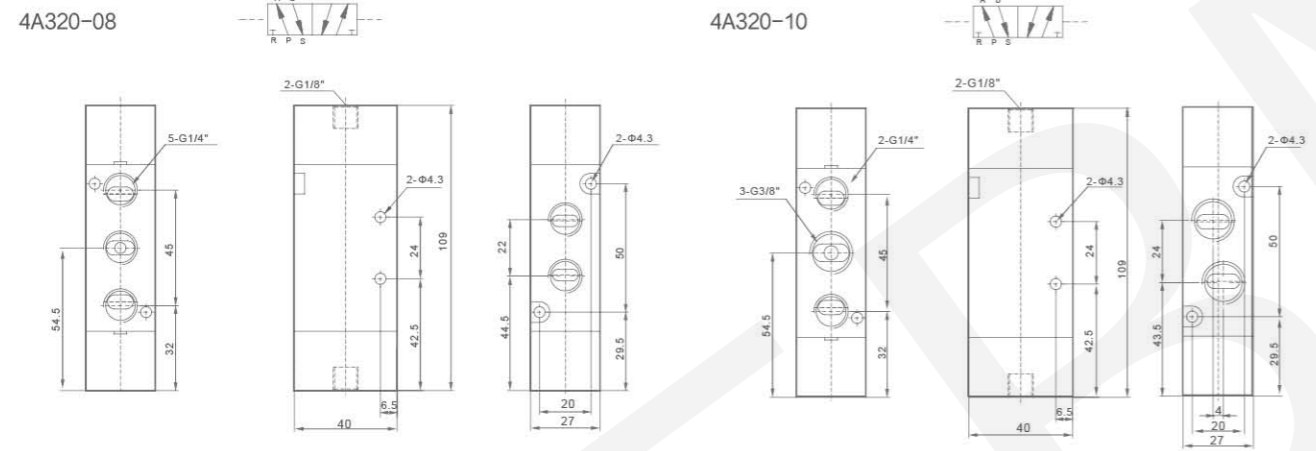
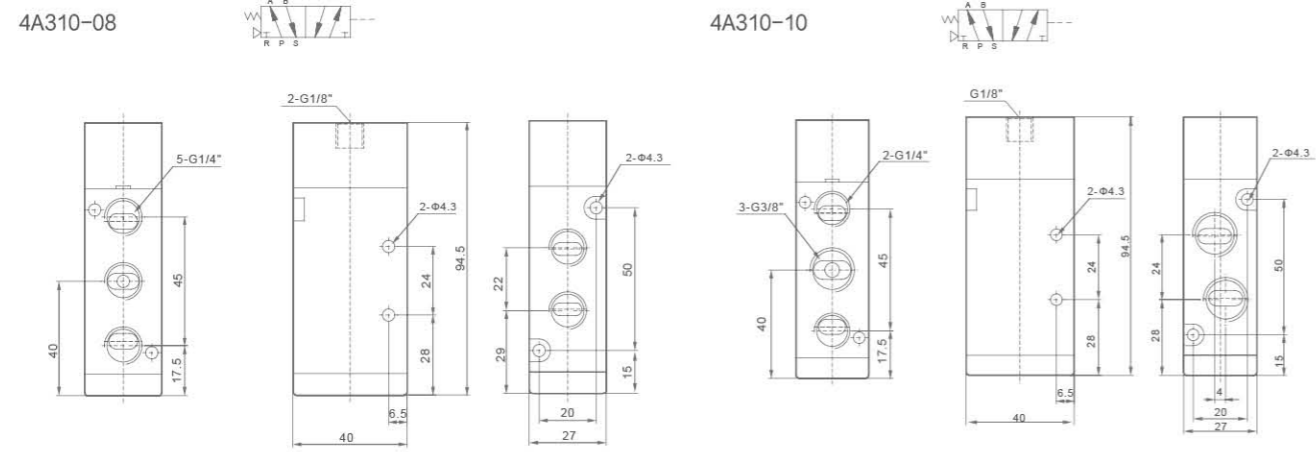

4V、3V300 Series Solenoid Valve, 4A、3A300 Series Pneumatic Control Valve

Overall Dimensions

